

PART OF WARD 23 CITY OF BOSTON. Scale 200 Feet to the Inch.

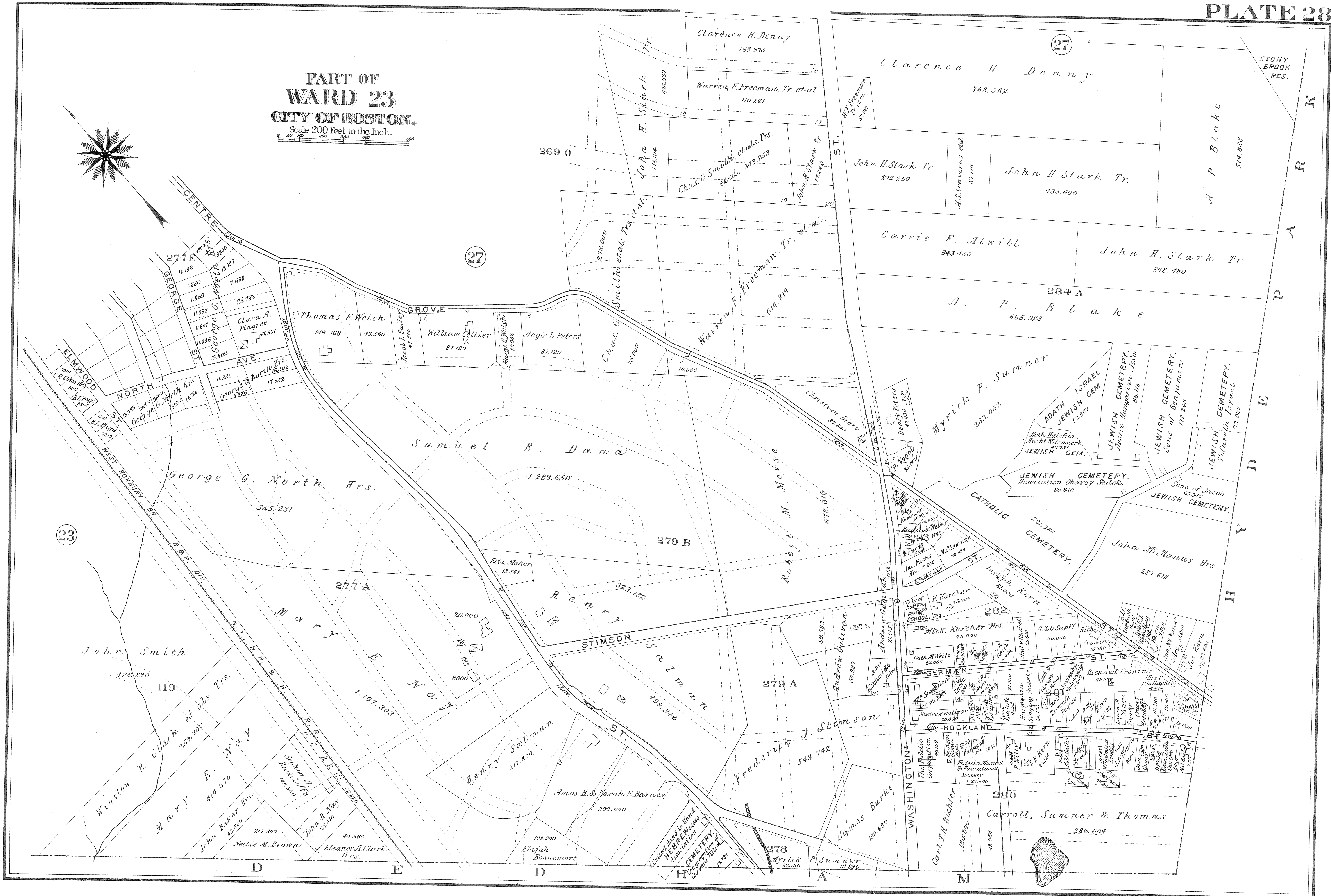
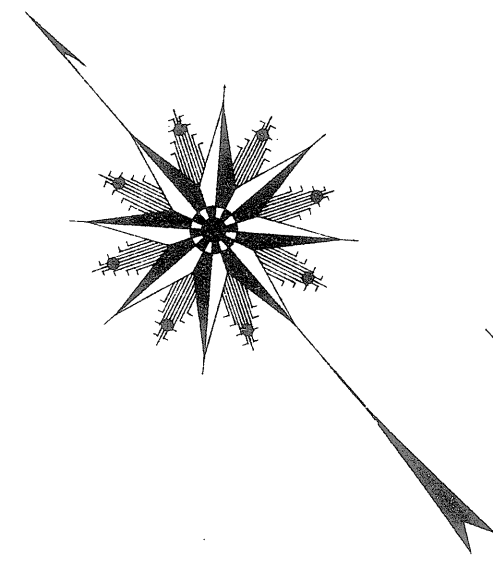

STONY BROOK RES.

ST. A R K
P A R K
D E F
H Y D

23

27

27

277 A

279 B

279 A

282

281

280

278

277 E
16.193
11.880
11.869
11.858
11.847
11.836
13.802

277
11.886
11.886
16.502
17.552

George G. North Hrs.
555.231

John Smith
426.890
119
Winslow B. Clark et als Trs.
259.200
Mary E. Way
414.670
John Baker Hrs.
43.560
Nellie M. Brown
217.800
John H. Nay
25.640
Eleanor A. Clark Hrs.
43.560

Thomas F. Welch
149.368
43.560
William Collier
87.120
Angie L. Peters
87.120
Chas. G. Smith, et als Trs. et al.
238.000
Warren F. Freeman, Tr. et al.
614.814

Samuel B. Dana
1.289.650

Mary E. Way
1.197.303
Henry Salzman
217.800
Amos H. & Sarah E. Barnes
392.040
Elijah Bonnemart
108.900

Clarence H. Denny
168.975
Warren F. Freeman, Tr. et al.
110.261
John H. Stark Tr.
272.250
Carrie F. Atwill
348.480
John H. Stark Tr.
435.600
John H. Stark Tr.
348.480
A. P. Blake
665.923

Myrick P. Sumner
263.062
ADATH ISRAEL JEWISH GEM.
52.869
JEWISH GEMETERY.
Jewish Hungarian Assn.
36.118
JEWISH GEMETERY.
Sons of Benjamin
112.240
JEWISH GEMETERY.
Tifarek Israel.
89.992
CATHOLIC GEMETERY.
221.738
John M. Manus Hrs.
287.618

Joseph Kern
81.000
F. Karcher
45.000
Mich. Karcher Hrs.
45.000
A. & O. Steff
40.000
Richard Cronin
40.000
Richard Cronin
40.000
Mrs. P. Gaudin
14.176
The Hebrew Association
27.500
F. W. Kern
25.254
Carroll, Sumner & Thomas
286.604