

PART OF  
WARDS 10 & 19  
CITY OF BOSTON.

Scale 100 feet to the inch.

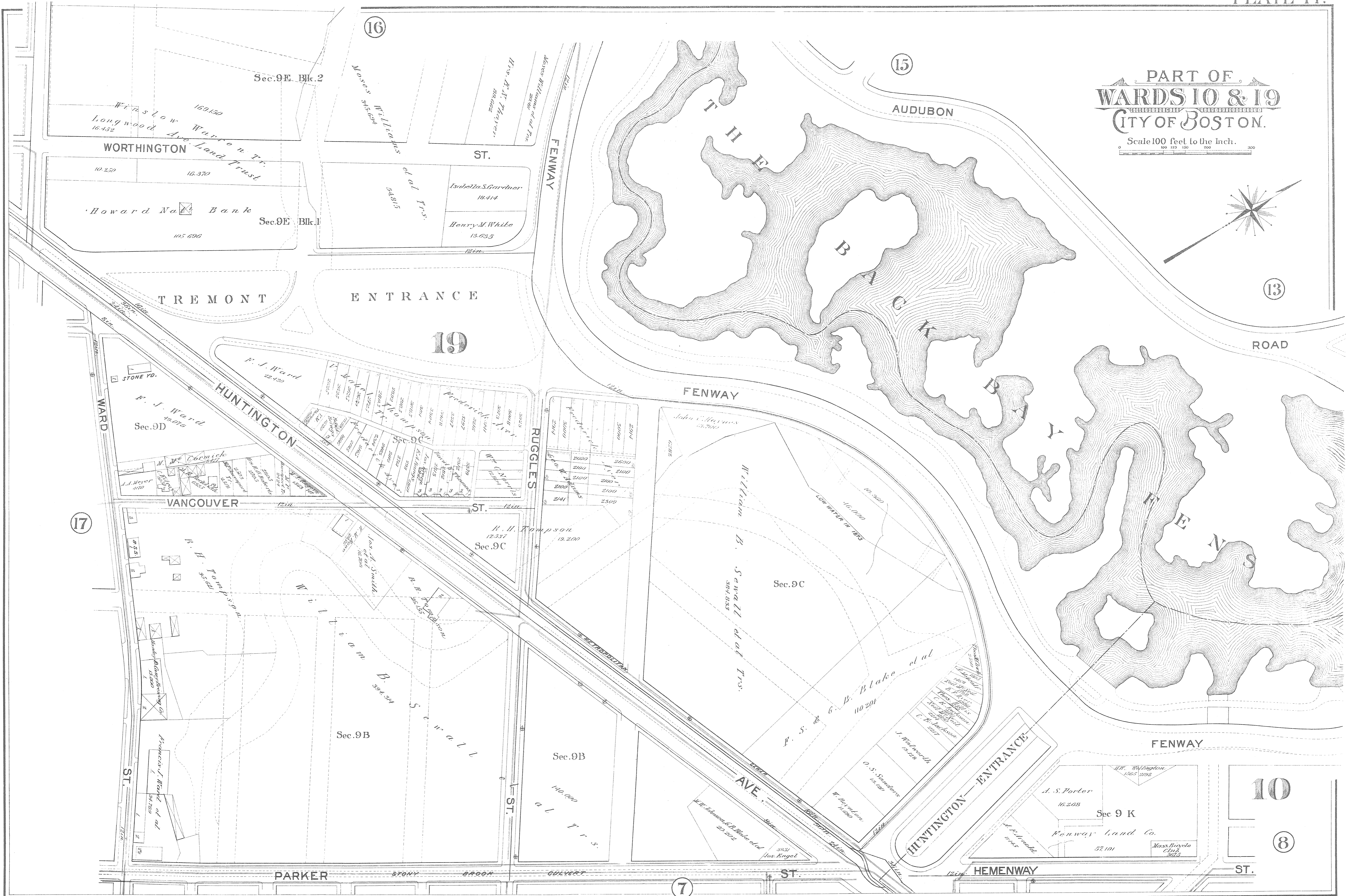
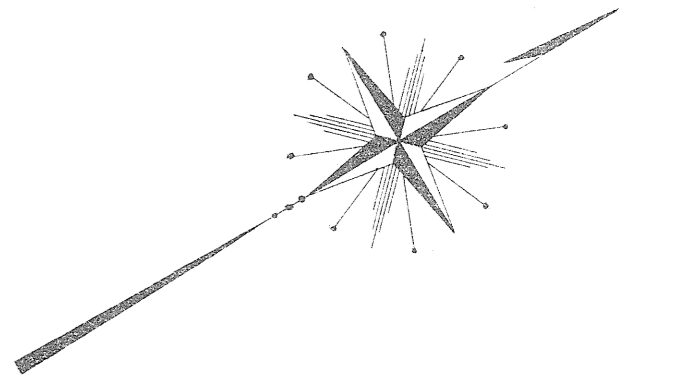

16

15

13

17

10

8

7

Sec. 9E Blk. 2

ST.

Sec. 9E Blk. 1

TREMONT

ENTRANCE

19

FENWAY

ROAD

HUNTINGTON

VANGOUVER

RUGGLES

ST.

Sec. 9C

Sec. 9B

Sec. 9B

ST.

AVE.

HUNTINGTON—ENTRANCE

FENWAY

PARKER

STONY

BROOK

QUIVERT

ST.

HEMENWAY

ST.

WINSLOW  
Longwood Ave Land Trust  
16-452  
16-370

Howard Nat Bank  
105 696

Moses Williams  
et al Trs.  
54815

Isabella S. Gardner  
18414  
Henry M. White  
13,635

H. J. Ward  
22,450  
Sec. 9D

M. Mc Cormick  
et al Trs.  
10,000

H. H. Thompson  
55,500

Frederick J. Ward  
et al  
14,750

W. J. Ward  
et al Trs.  
12,000

W. J. Ward  
et al Trs.  
12,000

W. J. Ward  
et al Trs.  
12,000

W. J. Ward  
et al Trs.  
12,000

H. H. Thompson  
19,200  
Sec. 9C

H. H. Thompson  
19,200  
Sec. 9C

H. H. Thompson  
19,200  
Sec. 9C

H. H. Thompson  
19,200  
Sec. 9C

William B. Sewall  
et al Trs.  
304,833  
Sec. 9C

F. S. & G. B. Blake  
et al  
102,201

J. MacArthur  
2025  
O. S. Sanders  
14,150  
W. Gardner  
1,000

A. S. Porter  
16,208  
Sec 9 K  
Fenway Land Co.  
57,101  
Miss Broyde  
Clara  
500

W. J. Ward  
19,200